

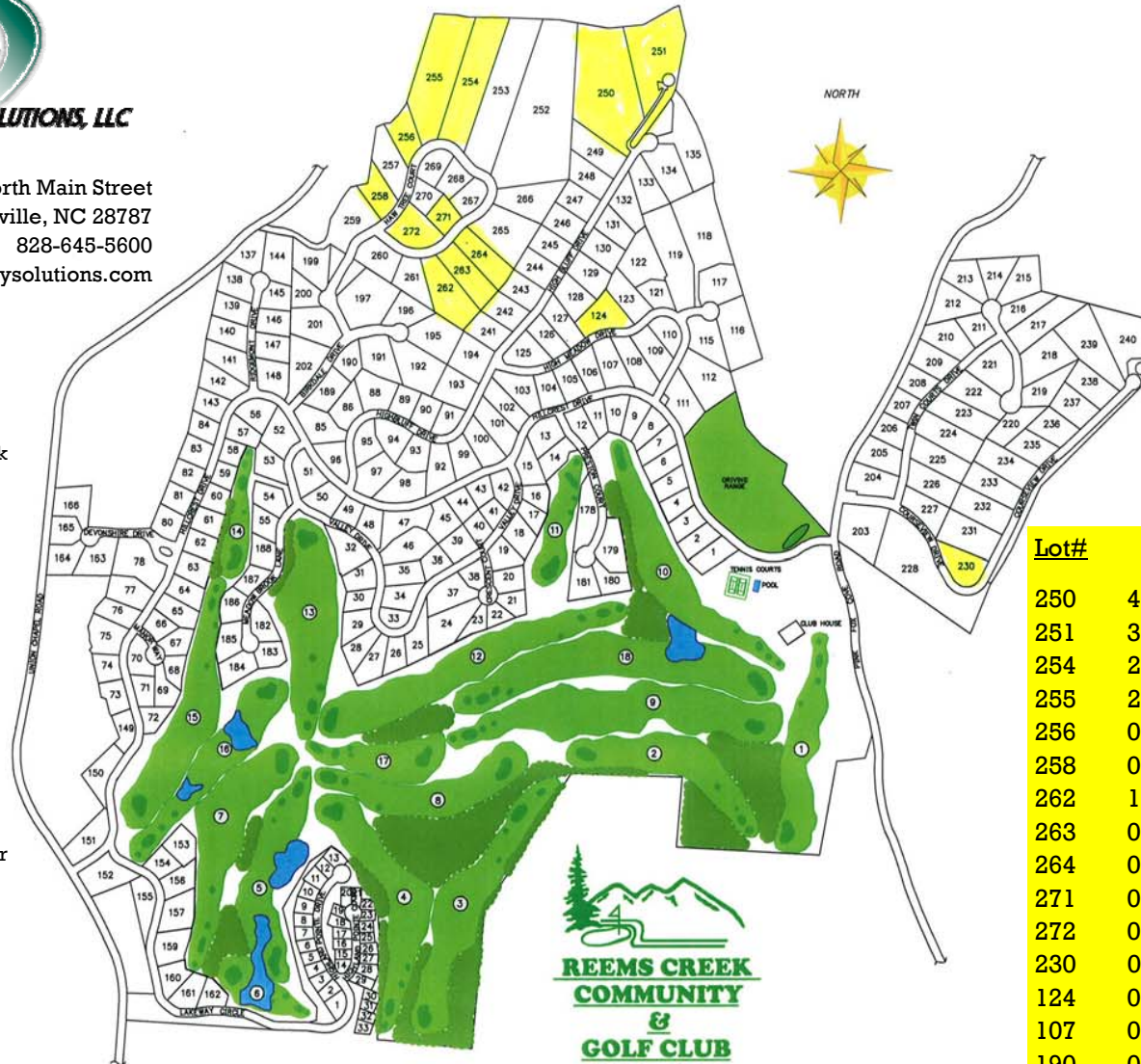

55 North Main Street  
 Weaverville, NC 28787  
 828-645-5600  
 www.m7realtysolutions.com

**What does the Reems Creek Golf Community Offer?**

- 18 hole golf course
- driving range
- clubhouse and grill
- swimming pool
- tennis courts
- picturesque lakes
- panoramic views
- underground utilities
- natural gas
- public water and sewer
- paved streets
- street lights
- garbage pick up
- public fire and police protection



Lot#	Size	Price
250	4.12 Acre	\$89,000
251	3.02 Acre	\$99,000
254	2.60 Acre	\$179,000
255	2.77 Acre	\$159,000
256	0.61 Acre	\$79,000
258	0.69 Acre	\$89,000
262	1.24 Acre	\$79,000
263	0.94 Acre	\$69,000
264	0.99 Acre	\$74,000
271	0.51 Acre	\$59,000
272	0.74 Acre	\$93,000
230	0.77 Acre	\$199,000
124	0.81 Acre	\$99,000
107	0.65 Acre	\$89,700
190	0.57 Acre	\$83,900

